

ADDENDUM NO. 1

PROJECT: **Demolition of 3 bldgs. At Villa Griffin Homes**

ISSUE DATE: January 12, 2018

BY: The Housing Authority of East St. Louis
700 North 20th Street
East St. Louis Illinois 62205

DOCUMENT DATE: January 24, 2018

BID DUE DATE: **February 16, 2018 at 3:00 PM**

The following revisions, modifications, and/or clarifications shall apply to the Documents for this project.

The Bid Due Date:

Remains the Same

Has Been Rescheduled

This addendum is issued before the execution of the contract to inform Contractors of revisions to the IFB documents referenced above. This addendum is hereby made a part of the IFB documents and shall be included in the contract.

The requirements contained in the IFB documents shall apply to this addendum. The work called for in this addendum shall be the same as set forth in the applicable portions of the IFB documents unless otherwise specified in this addendum. All incidental work necessitated by this addendum, as required to properly complete the work, shall be included in the IFB even though not specifically stated in this addendum.

CORRECTION:

1. Additional solicitation requirements on the Solicitation, Offer and Award form says bids are due February 9, and page 3 of IFB 18-BDEMO Schedule of Events, says bid are due at 4 p.m.

Correction is as follows: *Bids are due February 16, 2018 at 3:00 p.m.*

2. Remove bid sheet from packet and do not submit it. Bid sheet is no longer required. Do not check "Bid Form" box on Checklist form. Contractors are to indicate bid amount on Solicitation, Offer and Award form in Section 2: Offer Section, on the line next to "**Total cost of work:**" Please legibly write or type the amount of the bid numerically.
3. Please find larger site drawing attached.

END OF ADDENDUM

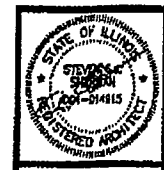

ESLHA VILLA GRIFFIN
DEMOLITION

SITE DEMOLITION & PARTIAL NEW
WORK AT COMMUNITY BUILDING

JOB NO.	1772
DATE	01/12/16
DRAWN	HM
CHECKED	KVM
COPYRIGHT © 2015 SHERMAN CARTER BARNHART ARCHITECTS, P.L.L.C.	

REVISIONS		
No.	Description	Date

SHEET
DS1.0

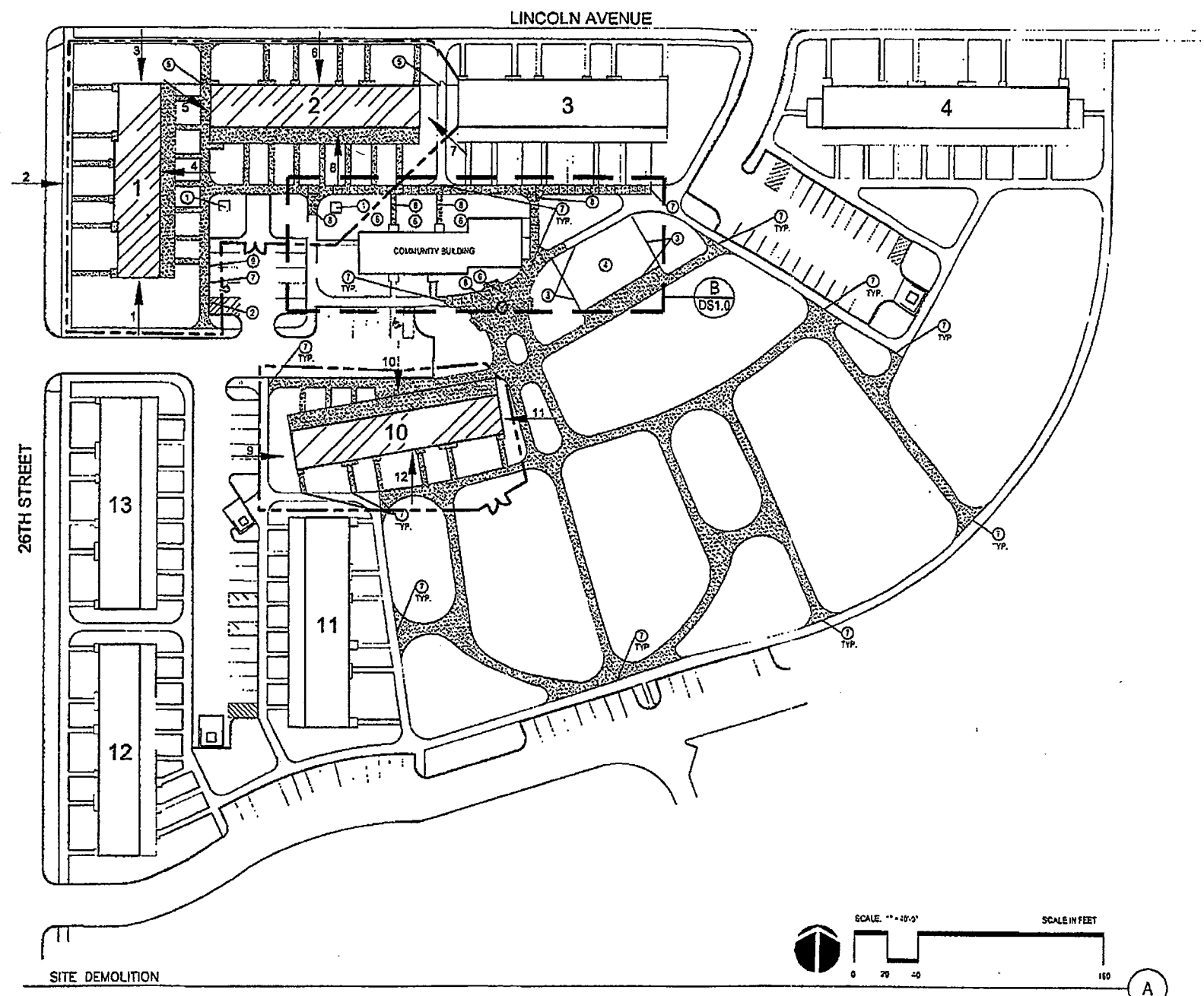

SITE DEMOLITION

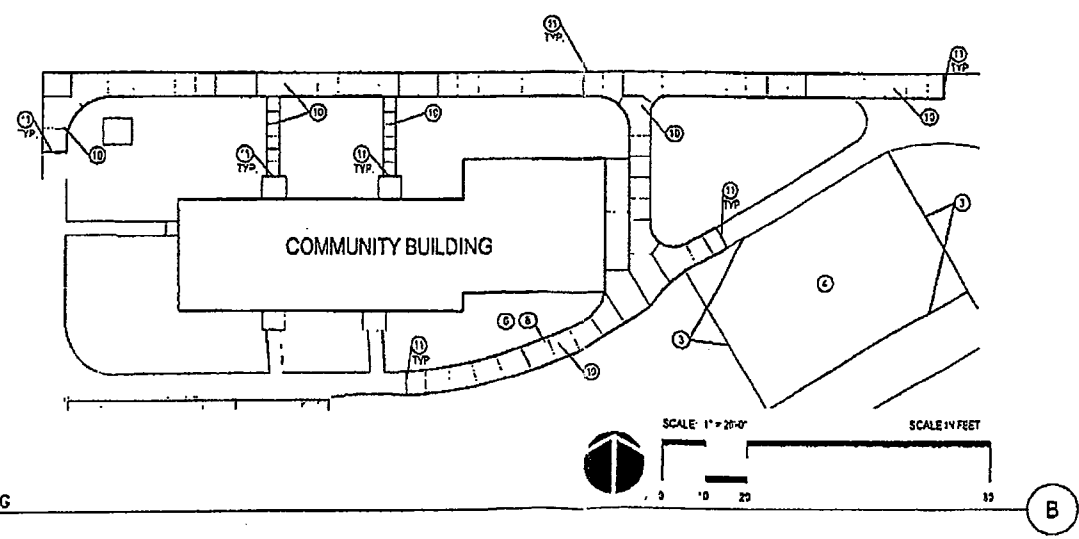

PARTIAL NEW WORK AT COMMUNITY BUILDING

LEGEND

	DENOTES EXISTING BUILDING TO BE DEMOLISHED COMPLETELY
	DENOTES EXISTING CONCRETE SIDEWALK STOOP/PAVING AND SUB-BASE TO BE REMOVED COMPLETELY
	DENOTES LOCATION OF CONSTRUCTION FENCE
	DENOTES LOCATION OF CONSTRUCTION ENTRANCE/ GATES
PHOTO #	REFER TO PHOTOGRAPHS INCLUDED IN PROJECT MANUAL FOR REFERENCE PURPOSES ONLY

REFER TO 'SCOPE OF WORK' INCLUDED IN PROJECT MANUAL.

GENERAL NOTES

- A) ALL EXISTING TREES TO REMAIN UNLESS OTHERWISE NOTED
- B) ALL EXISTING SITE LIGHTING TO REMAIN UNLESS OTHERWISE NOTED

TAG NOTES

- 1 TRANSFORMER TO REMAIN
- 2 FIRE HYDRANT TO REMAIN
- 3 REMOVE CURBS AT PLAYGROUND COMPLETELY
- 4 REMOVE ROCK FROM PLAYGROUND COMPLETELY AND FILL WITH SOIL AND SEED TO MATCH ADJACENT GRADE
- 5 REMOVE FENCING AND GATES COMPLETELY
- 6 ADJUST GRADE FOR POSITIVE DRAINAGE AWAY FROM BUILDING
- 7 SAWCUT PAVEMENT
- 8 REMOVE EXISTING CONCRETE WALK. ADJUST GRADE FOR POSITIVE DRAINAGE AWAY FROM BUILDING
- 9 PROVIDE NEW CONCRETE CURB ALONG LENGTH OF EXISTING PARKING LOT. TIE INTO EXISTING CURB. WATCH EXISTING CURB THICKNESS AND ELEVATION
- 10 NEW CONCRETE WALK TO MATCH EXISTING WALK WIDTH, THICKNESS, FINISH, AND JOINT TYPE (REFER TO SPECIFICATIONS FOR ADDITIONAL REQUIREMENTS). TOP OF NEW CONCRETE WALKS SHALL ALIGN FLUSH WITH ANY ADJACENT EXISTING WALKS.
- 11 PROVIDE 1/2" EXPANSION JOINT AND SEALANT IN ALL LOCATIONS WHERE NEW WALK ABUTS EXISTING WALK